

Coaxial

Low Noise Amplifier

ZEL-1724LN

50Ω

1700 to 2400 MHz

Features

- very low noise, 1.5 dB max.
- wideband, 1700 to 2400 MHz
- rugged shielded case

Applications

- PCS/DCS
- UMTS
- communication systems



CASE STYLE: EEE132

Connectors	Model	Price	Qty.
SMA	ZEL-1724LN	\$274.95 ea.	(1-9)

Low Noise Amplifier Electrical Specifications

MODEL NO.	FREQUENCY (MHz)		NOISE FIGURE (dB)	GAIN (dB)		MAXIMUM POWER (dBm)		INTERCEPT POINT (dBm)	VSWR (:1) Max.		DC POWER	
	f_L	f_U		Min.	Flatness Max.	Output (1 dB Compr.) Typ.	Input (no damage)		IP3 Typ.	In	Out	Volt (V) Nom.
ZEL-1724LN	1700	2400	1.5	20	±1.0	+8	+13	+22	2.5	2.5	15	70

Noise Figure specified at room temperature, increases to 2 dB typical at +85°C
 Open load is not recommended, potentially can cause damage.
 With no load derate max input power by 20 dB

Maximum Ratings

Operating Temperature	-54°C to 85°C
Storage Temperature	-55°C to 100°C
DC Voltage	+17V Max.

Outline Drawing

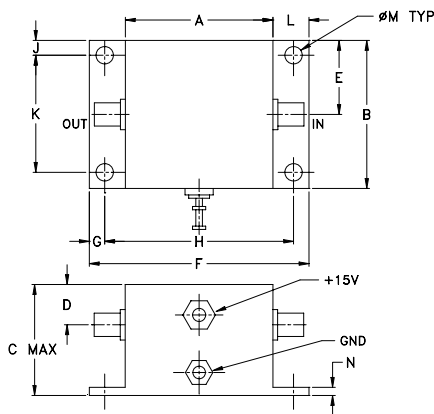

Outline Dimensions (inch/mm)

A	B	C	D	E	F	G	H	J	K	L	M	N	wt
.90	.90	.675	.245	.45	1.34	.09	1.152	.09	.712	.22	.106	.05	grams
22.86	22.86	17.15	6.22	11.43	34.04	2.29	29.26	2.29	18.08	5.59	2.69	1.27	50.0



P.O. Box 350166, Brooklyn, New York 11235-0003 (718) 934-4500 Fax (718) 332-4661 For detailed performance specs & shopping online see Mini-Circuits web site



The Design Engineers Search Engine Provides ACTUAL Data Instantly From MINI-CIRCUITS At: www.minicircuits.com

RF/IF MICROWAVE COMPONENTS

FREQUENCY (MHz)	GAIN (dB)			DIRECTIVITY (dB)			VSWR (:1)		NOISE FIGURE (dB)	POUT at 1 dB COMPR. (dBm)
	12V	15V	16V	12V	15V	16V	IN	OUT		
1700.00	22.23	22.96	23.14	12.70	12.80	12.70	1.61	1.64	1.28	11.46
1751.20	22.22	22.90	23.05	12.50	12.70	12.70	1.63	1.65	1.31	11.45
1821.90	22.16	22.78	22.91	12.60	12.70	13.00	1.66	1.65	1.40	11.64
1895.50	22.19	22.77	22.88	12.50	13.00	13.10	1.69	1.60	1.45	11.65
1969.20	22.29	22.79	22.90	12.30	12.40	13.00	1.68	1.55	1.47	11.79
2041.00	22.43	22.91	23.01	11.70	12.20	12.60	1.65	1.48	1.46	11.86
2130.80	22.78	23.21	23.29	10.80	11.90	12.20	1.55	1.38	1.39	12.00
2220.50	23.39	23.73	23.77	10.00	11.10	11.10	1.37	1.29	1.32	12.00
2310.30	23.58	23.96	24.02	9.30	9.90	10.20	1.23	1.38	1.31	11.58
2400.00	23.02	23.65	23.75	9.80	10.20	10.00	1.50	1.77	1.44	10.58

