

## TYPE B4F: Surface Mount

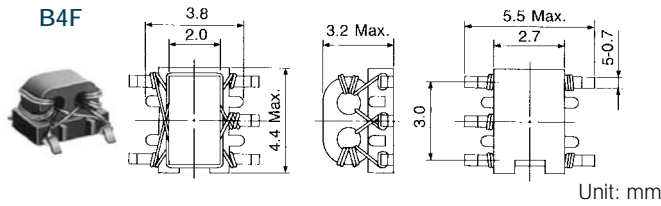

## TYPE B5FL: Surface Mount

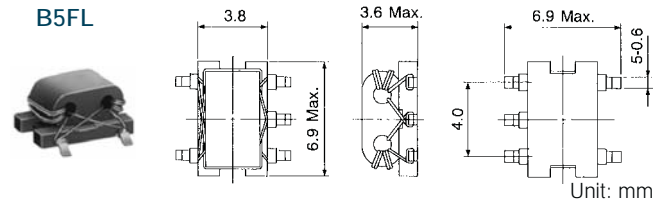

## Features

- Pair wire coil for high stability.
- Base pin terminal treated, allowing mounting 'as is' on a PCB.

## Applications

- Double balance mixers, broad-band transformers, impedance transformers, etc.

## STANDARD TRANSFORMERS SELECTION GUIDE

TYPE B4F					
TOKO Part Number	Number of Turns per Winding	Operating Frequency Range (MHz)	Insertion Loss (dB)	Fig.	
Double Balanced Mixer					
617DB-1007	2	25~2000	3	1	
617DB-1009	3	6~2000	3	1	
617DB-1006	3	150~2300	3	1	
617DB-1010	4	3.5~2000	3	1	
617DB-1018	5	2~2000	3	1	
Frequency Mixer					
617PT-1025	1	—		2	
617PT-1019	2	8~750	3	2	
617PT-1026	3	3.5~700	3	2	
Balun Transformer					
617DB-1021	1½	20~750	3	3	
617DB-1022	2½	4.5~3300	3	3	
617DB-1023	3½	2.3~2700	3	3	
617DB-1024	4½	1.5~2400	3	3	
Distributor					
617DS-1079	2	1300~1700	IN to OUT-1,2 4.5dB max.	5	
617DS-1076	3	800~1000	IN to OUT-2 (ISOLATION) 15dB min.	5	

TYPE B5FL					
TOKO Part Number	Number of Turns per Winding	Operating Frequency Range (MHz)	Insertion Loss (dB)	Fig.	
Double Balanced Mixer					
616DB-1003	2	30~850	3	1	
616DB-1004	3	6.5~1000	3	1	
616DB-1007	4	3.5~1600	3	1	
616DB-1008	5	2.5~1500	3	1	
Frequency Mixer					
616PT-1027	1	—	3	2	
616PT-1028	2	8~550	3	2	
616PT-1029	3	3.5~500	3	2	
616PT-1030	4	2~370	3	2	
616PT-1037	1	—	3	2	
616PT-1038	2	500~850	3	2	
616PT-1039	3	240~500	3	2	
616PT-1040	4	85~380	3	2	
Balun Transformer					
616DB-1048	1½	5.5~850	3	3	
616DB-1049	2½	2.5~2000	3	3	
616DB-1050	3½	1.2~1700	3	3	
616DB-1051	4½	0.8~1400	3	3	
616DB-1078	5½	0.6~1300	3	3	
Balun Transformer					
616DB-1053	1½	160~2200	3	4	
616DB-1017	2½	55~1700	3	4	
616DB-1054	3½	30~1400	3	4	

## Pin Connections

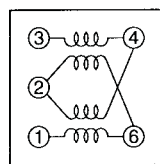
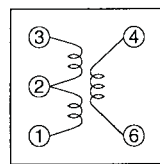
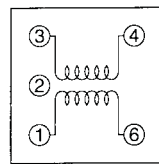
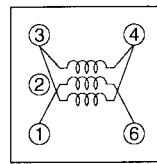
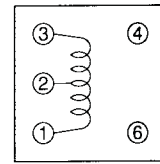
Double balanced  
Fig. 1Mixer transformer  
Fig. 2Balun transformer  
Fig. 3Balun transformer  
Fig. 4Distributor  
Fig. 5