

A (2:1)

DSN 8.4 GHz Bandpass Filter

Louis Cupido, CT1DMK

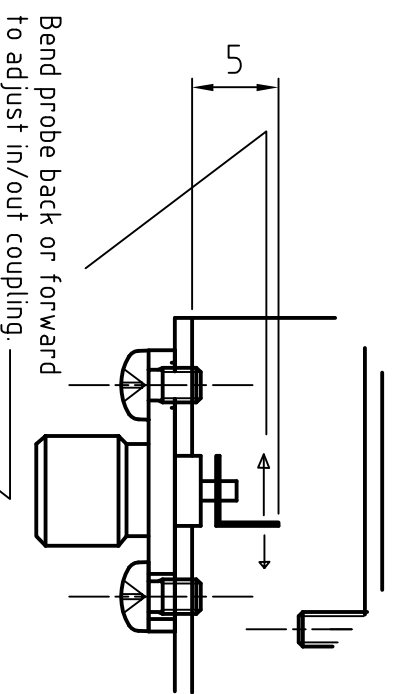

Filter Dimensions are symmetrical
e position is $A/2$ of $x - x$
('c' screws are half-way between 'a' screws)

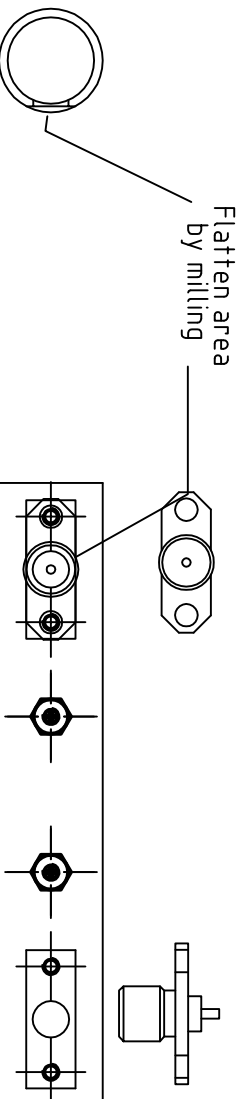
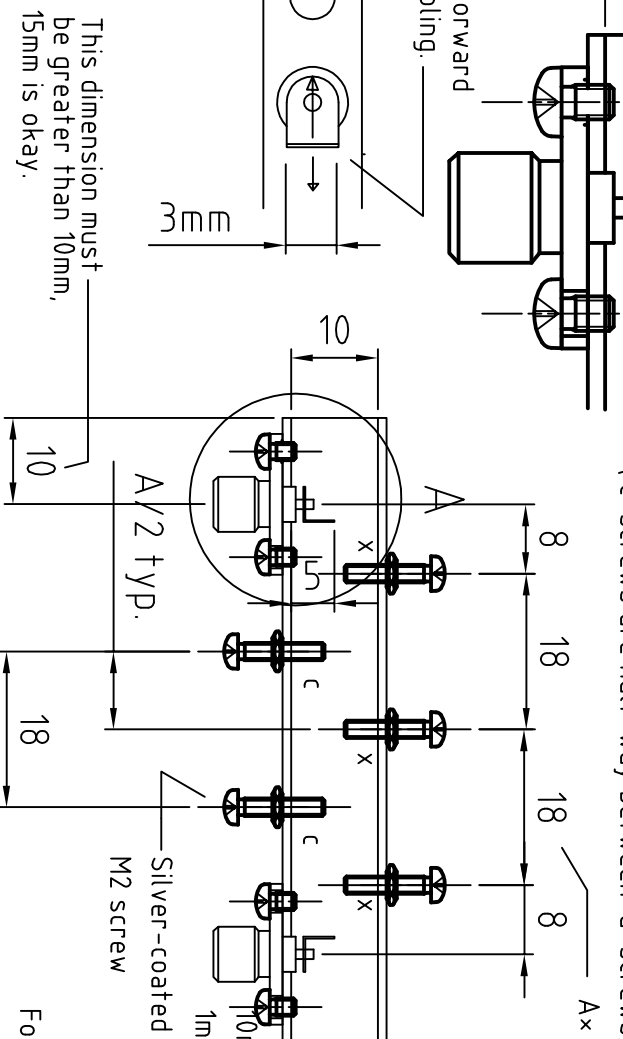

LOWER LOSS	$\times A - 16\text{mm}$
	Allow narrow band tuning from 50 MHz to 300 MHz and +
NARROW BAND	$\times A - 18\text{mm}$
	Allow narrow band tuning from 20 MHz BW to 250 MHz

10mm ID Copper tubing
1mm wall is ok; 2mm wall is better

Silver-coated
M2 screw

x - Tuning screws
c - coupling screws

For 100 MHz BW @ -30 dB:
Approx: -30 dB 100MHz below/above
Approx: -45 dB 200MHz below/above

Drawn by: K6HIJ
5/1/06