

SPECIFICATION

CUSTOMER : 無線電制作大賣場	APPROVED BY
CUS. PART NO. : DIY10-14	
COILS PART NO. : KT1C-868725	
DATE : 2002/05/06	

1. DIMENSIONS (UNIT : mm)

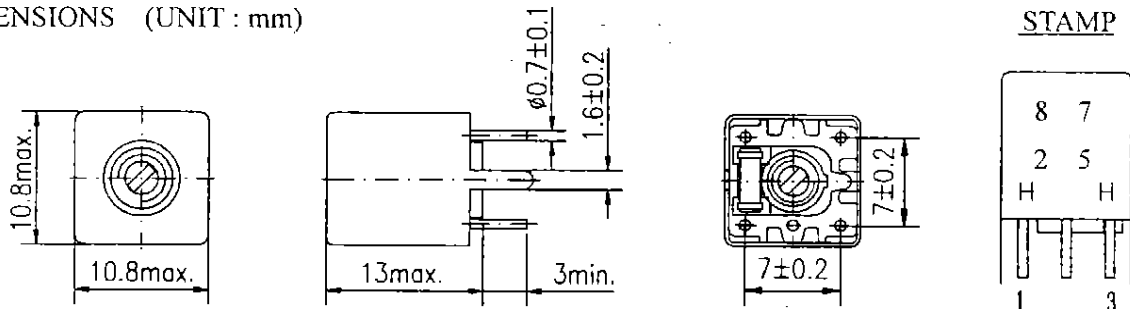

2. CONNECTION (BOTTOM)

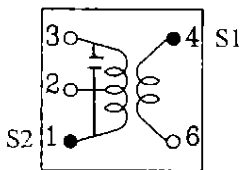

3. TURNS, WIRE AND CORE

PIN. NO.	4-6	1-2	2-3	
TURNS (Ref.)	4 T	6 T	6 T	
WIRE	Ø0.10mm (2UE-FPW 10.7MHz)			
SCREW CORE	CM11 OR EQUIVALENT			
POT CORE	CM11 OR EQUIVALENT			

4. CHARACTERISTICS

ITEM	SPEC. (1-3)	MEASUREMENT CONDITIONS
CENTER FREQUENCY	14.15 MHz	
VARIABLE FREQUENCY	14.15 MHz ± 3% Min.	
UNLOADED Q	75 Min.	14.15 MHz
INT. CAPACITY	68 pF ± 5%	
MEASUREMENT INSTRUMENT	MQ-1601	

EXT. STRAY CAP. 0 pF (1-3)

5. GENERAL CHARACTERISTICS:

- ① Core Torque : 10 ~ 250gf · cm
- ② Dielectric Strength: No abnormality at 100V D.C. for 1 minute between winding-winding, winding-case.
- ③ Insulation Resistance: Over 100MΩ at 100V D.C. between winding-winding, winding-case.
- ④ Humidity Test : Frequency (Inductance) deviation within ±0.5% (±1%)
Deviation of Q within ±20%
After 96±4 hours in 90~95% relative humidity at 40°C±2°C and 60 minutes drying under normal condition.
- ⑤ Temperature Test : Frequency (Inductance) deviation within ±0.5% (±1%)
Deviation of Q within ±20%
a. After 6 hours at -25°C±3°C and 1 hour later under normal condition.
b. After 6 hours at 85°C±2°C and 1 hour later under normal condition.
- ⑥ Terminal Strength : No abnormality at 0.3kg for 30±5 seconds (pull and push).
- ⑦ Terminal Heat Test: No abnormality at 250°C±5°C for 5 seconds.

6. REMARKS:

APPROVAL	CHECK	DESIGN	REVISION

SPECIFICATION

CUSTOMER : 無線電制作大賣場	APPROVED BY
CUS. PART NO. : DIY10-21	
COILS PART NO. : KT1C-868726	
DATE : 2002/05/06	

1. DIMENSIONS (UNIT : mm)

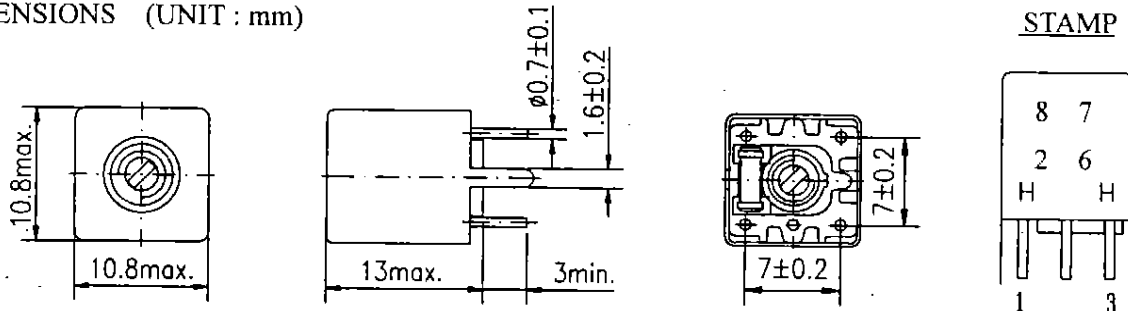

2. CONNECTION (BOTTOM)

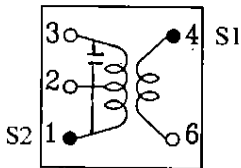

3. TURNS, WIRE AND CORE

PIN. NO.	4-6	1-2	2-3	
TURNS (Ref.)	4 T	6 T	6 T	
WIRE	Ø0.12mm (2UEW)			
SCREW CORE	CM11 OR EQUIVALENT			
POT CORE	CM11 OR EQUIVALENT			

4. CHARACTERISTICS

ITEM	SPEC. (1-3)	MEASUREMENT CONDITIONS
CENTER FREQUENCY	21.20 MHz	
VARIABLE FREQUENCY	21.20 MHz ± 3% Min.	
UNLOADED Q	75 Min.	21.20 MHz
INT. CAPACITY	39 pF ± 5%	
MEASUREMENT INSTRUMENT	MQ-1601	

EXT. STRAY CAP. 0 pF (1-3)

5. GENERAL CHARACTERISTICS:

- ① Core Torque : 10 ~ 250gf · cm
- ② Dielectric Strength: No abnormality at 100V D.C. for 1 minute between winding-winding, winding-case.
- ③ Insulation Resistance: Over 100MΩ at 100V D.C. between winding-winding, winding-case.
- ④ Humidity Test : Frequency (Inductance) deviation within ±0.5% (±1%)
Deviation of Q within ±20%
After 96±4 hours in 90~95% relative humidity at 40°C±2°C and 60 minutes drying under normal condition.
- ⑤ Temperature Test : Frequency (Inductance) deviation within ±0.5% (±1%)
Deviation of Q within ±20%
a. After 6 hours at -25°C±3°C and 1 hour later under normal condition.
b. After 6 hours at 85°C±2°C and 1 hour later under normal condition.
- ⑥ Terminal Strength : No abnormality at 0.3kg for 30±5 seconds (pull and push).
- ⑦ Terminal Heat Test: No abnormality at 250°C±5°C for 5 seconds.

6. REMARKS:

APPROVAL	CHECK	DESIGN	REVISION
			YW

SPECIFICATION

CUSTOMER : 無線電制作大賣場	APPROVED BY
CUS. PART NO. : DIY10-7	
COILS PART NO. : KT1C-868724	
DATE : 2002/05/06	

1. DIMENSIONS (UNIT : mm)

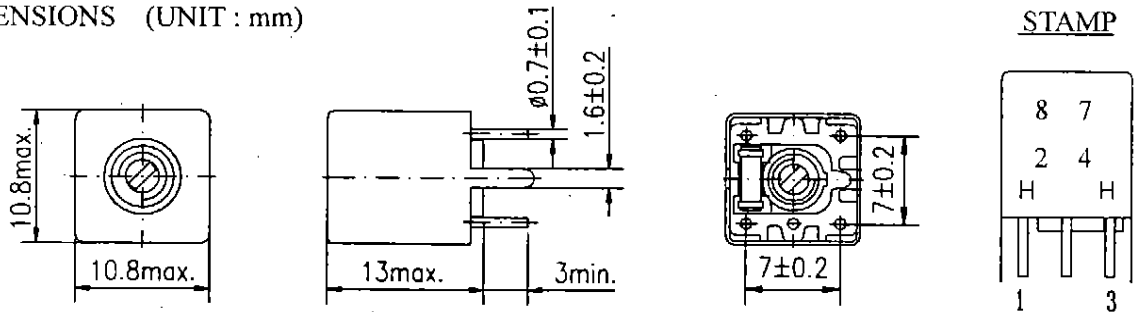

2. CONNECTION (BOTTOM)

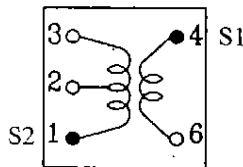

3. TURNS, WIRE AND CORE

PIN. NO.	4-6	1-2	2-3	
TURNS (Ref.)	6 T	9 T	9 T	
WIRE	Ø0.10mm (2UE-FPW 10.7MHz)			
SCREW CORE	CM11 OR EQUIVALENT			
POT CORE	CM11 OR EQUIVALENT			

4. CHARACTERISTICS

ITEM	SPEC. (1-3)	MEASUREMENT CONDITIONS
CENTER FREQUENCY	7.05 MHz	
VARIABLE FREQUENCY	7.05 MHz±3% Min.	
UNLOADED Q	75 Min.	7.05 MHz
INT. CAPACITY	120 pF±5%	
MEASUREMENT INSTRUMENT	MQ-1601	

EXT. STRAY CAP. 0 pF (1-3)

5. GENERAL CHARACTERISTICS:

- ① Core Torque : 10 ~ 250gf · cm
- ② Dielectric Strength: No abnormality at 100V D.C. for 1 minute between winding-winding, winding-case.
- ③ Insulation Resistance: Over 100MΩ at 100V D.C. between winding-winding, winding-case.
- ④ Humidity Test : Frequency (Inductance) deviation within ±0.5% (±1%)
Deviation of Q within ±20%
After 96±4 hours in 90~95% relative humidity at 40°C±2°C and 60 minutes drying under normal condition.
- ⑤ Temperature Test : Frequency (Inductance) deviation within ±0.5% (±1%)
Deviation of Q within ±20%
a. After 6 hours at -25°C±3°C and 1 hour later under normal condition.
b. After 6 hours at 85°C±2°C and 1 hour later under normal condition.
- ⑥ Terminal Strength : No abnormality at 0.3kg for 30±5 seconds (pull and push).
- ⑦ Terminal Heat Test: No abnormality at 250°C±5°C for 5 seconds.

6. REMARKS:

APPROVAL	CHECK	DESIGN	REVISION
			YW